

KEY	PRODUCT	MNFR	PRODUCT #	COLOR	SIZE	ADDITIONAL INFORMATION
FLOORING						
CP-1	MODULAR CARPET TILES	TBD	TBD	TBD	24"X24"	INSTALL CP-1 AND CP-2 IN RANDOM PATTERN WITH 70% - CP-1, 30% - CP-2 MIX.
CP-2	MODULAR CARPET TILES	TBD	TBD	TBD	24"X24"	INSTALL CP-1 AND CP-2 IN RANDOM PATTERN WITH 70% - CP-1, 30% - CP-2 MIX.
CP-3	MODULAR CARPET TILES	INTERFACE	832402500	105558 - FLINT	24"X24"	NON DIRECTIONAL INSTALLATION PATTERN
RT01	RESILIENT FLOORING	SHAW CONTRACT	GRAIN-0364V	ASHEN 64155	7'X48"	
RT03	RESILIENT FLOORING	ARMSTRONG	52126	GRAVEL BLUE	12"X12"	VINYL COMPOSITION TILE
WALL BASE						
B-1	RUBBER WALL BASE	ROPPE	93	BLACK BROWN	4"	RUBBER COVE BASE - CONTINUOUS COIL
PLASTIC LAMINATE						
PL-1	PLASTIC LAMINATE	WILSON ART	7960K-18	STUDIO TEAK	N/A	INTERIOR DOORS
PL-2	PLASTIC LAMINATE	WILSON ART	7967K-12	PARK ELM	N/A	CABINET FACES - NEW MILLWORK IN EXISTING OPEN OFFICE AREA 100
PL-3						
PL-4	PLASTIC LAMINATE	WILSON ART	D91-60	SLATE GREY	N/A	COUNTERTOPS & LOW WALL CAPS IN EXISTING OPEN OFFICE AREA 100
PAINT						
P-1	PAINT	SHERWIN WILLIAMS				COLOR, FINISH & LOCATION TBD
P-2	PAINT	SHERWIN WILLIAMS				COLOR, FINISH & LOCATION TBD
P-3	PAINT	SHERWIN WILLIAMS				COLOR, FINISH & LOCATION TBD
P-4	PAINT	SHERWIN WILLIAMS				COLOR, FINISH & LOCATION TBD
P-5	PAINT	SHERWIN WILLIAMS				COLOR, FINISH & LOCATION TBD
P-6	PAINT	SHERWIN WILLIAMS				COLOR, FINISH & LOCATION TBD

02 FINISHES SCHEDULE

NOT TO SCALE

SHEET NOTES

- ALL WALL BASE TO BE R901 UNLESS NOTED OTHERWISE.
- PAINTED SURFACES TO RECEIVE PRIMER COAT & TWO COATS HIGHEST GRADE PAINT.
- REFERENCE FINISH PLAN, ELEVATIONS, MILLWORK SECTIONS & RCP FOR FINISH LOCATIONS.
- CONTRACTOR RESPONSIBLE FOR REPAIRING, REPLACING AND/OR MATCHING ANY FINISHES THAT SUSTAINED DAMAGE DURING DEMOLITION OR BUILD-OUT.
- ALL TAPE AND FLOAT SHALL RECEIVE LEVEL 4 GRADE FINISH TO WALLS AND LEVEL 5 GRADE FINISH TO CEILINGS.
- REFER TO INTERIOR ELEVATIONS FOR MILLWORK FINISHES.
- ALL FINISHES WILL COMPLY AND MEET REQUIRED FIRE RATINGS PER IBC 2006.
- CENTER ALL SCHED. FLOOR TILE PATTERNS WITHIN THE SPACE U.N.O.
- TYPICAL JOINT OF WALL TILE NOT TO EXCEED 1/8".
- CARPET PATTERN DIRECTION TO BE CONSISTENT THROUGHOUT U.N.O.
- DUE TO VARIATIONS IN TILE COLORATION, MIX TILE LOTS TO ACHIEVE A BALANCED COLOR MIX.
- FLOORING TRANSITIONS AT DOORWAYS SHALL BE CENTERED ON CENTER LINE OF DOOR PANEL THICKNESS.
- INSTALL CRACK-ISOLATION SHEET WITH FLOOR TILE AREAS OVER 150 SF OR LONGER THAN 20'-0" IN ANY DIMENSION, OR INSTALL CRACK-ISOLATION SHEET STRIPS TO SPAN ALL SAWCUT CONTROL JOINTS IN CONCRETE SLAB.
- INSTALL VCT ORTHOGONAL TO WALLS.
- ALL WALL PAINT TO BE "EGG-SHELL" LATEX WITH ROLLED "ORANGE PEE" FINISH, U.N.O.
- ALL CASEWORK INTERIORS TO BE WHITE MELAMINE, U.N.O.
- FLOAT OUT BASE LINE GYP. BD. WALLS, CHAIR RAIL LINE, CEILING MOULD LINE, AND AT COUNTER TRIMS FOR A STRAIGHT SUBSTRATE FOR WOOD OR TILE BASE, OR TRIM APPLICATIONS.
- ALL PAINT GRADE WOOD SHELVES TO BE SEMI-GLOSS LATEX ENAMEL.
- PROVIDE FLOORING COMPOUND AS REQUIRED FOR FLUSH FINISH OF CARPET, VCT, CERAMIC TILE AND DISSIMILAR STONE TO STONE JOINTS.
- ROLL GOODS CARPET TO BE DIRECT GLUE INSTALLATION, OR WITH PAD AS NOTED, SECURELY ATTACHED TO SUBSTRATE.
- CARPET TILES AND ENTRANCE MAT TILES SHALL BE SECURELY FASTENED WITH RELEASE GLUE.
- CARPET TILE HEIGHT SHALL NOT EXCEED 1/2" AT DISSIMILAR FLOOR FINISH JUNCTIONS. INSTALL COMPOUND FLOAT FOR FLUSH FINISH ELEVATION AS NECESSARY AND SECURELY FASTEN EDGES TO SUBSTRATE.
- DISSIMILAR HEIGHTS AND THRESHOLDS NOT TO EXCEED 1/2" IN HEIGHT AND HAVE 1:2 BEVEL IF MORE THAN 1/4".
- STAIN DISSIMILAR WOODS TO MATCH COMMON SELECTED STAIN COLOR TBD BY NM21 DESIGN STUDIO, LLC.
- MINIMUM OVERAGES: PROVIDE EXTRA STOCK FOR FUTURE REPAIR / REPLACEMENTS AS FOLLOWS: STOCK TO BE LEFT ON SITE AT LOCATION TO BE DETERMINED BY OWNER / TENANT.
- CEILING TILE = 2 BOXES CARPET = 5% FULL 1/2" ROLL PIECE W/ NO CUTS. LEAVE ANY UNUSED PIECES OF CARPET OVER 5 SF. SCRAPS NOT TO BE INCLUDED IN 5% OVERAGE CALCULATION. CARPET TILE = 2 BOXES OF TILES PER CARPET TILE PATTERN. PAINTSTAINS - MINIMUM 1 GALLON EACH COLOR AND TYPE. LABEL CANS CLEARLY AS TO USE (E: "WALL PAINT") VCT/CERAMIC TILE = 10 TILES OF EACH TYPE/COLOR MINIMUM.
- PROVIDE FLOOR TILE EDGE PROTECTOR AS FLOOR TILE TRANSITIONS TO DISSIMILAR MATERIAL. THIS INCLUDES ANY TILE OR INTERIOR PAWER, SCHLUTER-SHENE SATIN ANODIZED ALUMINUM EDGE PROTECTOR.
- PROVIDE PAINT AND STAIN OF UP TO ONE GALLON OF EACH COLOR SPECIFIED PRIOR TO PURCHASING THE REMAINDER. PREPARE SAMPLE AREAS AS REQUESTED BY THE TENANT/OWNER REPRESENTATIVE FOR EVALUATION AND APPROVAL. ADJUST COLOR SELECTIONS AND LOCATIONS AS DIRECTED BEFORE PROCEEDING.
- PROVIDE TEXTURE SAMPLES FOR ALL WALL AND CEILING FINISHES.
- PROVIDE CARPET LAYOUT PLAN FOR NM21 DESIGN STUDIO, LLC'S APPROVAL PRIOR TO ORDERING. RUN CARPET IN SAME DIRECTION WITHIN EACH SPACE. OBSERVE PATTERN DIRECTION AS NOTED ON PLANS.
- SUBMIT SAMPLES OF ALL FINISH MATERIALS FOR APPROVAL BY NM21 DESIGN STUDIO, LLC PRIOR TO ORDERING.
- NO SUBSTITUTIONS ALLOWED ON ANY INTERIOR FINISH MATERIALS WITHOUT APPROVAL FROM NM21 DESIGN STUDIO, LLC.
- PROVIDE "HI WEAR" TYPE LAMINATE FOR ALL COUNTERTOP APPLICATIONS SPECIFIED.
- ALL BATHROOM WALLS TO BE PAINTED GYP. BD. PAINT COLOR PT01 WITH WALL BASE T101 SIZED 4" X 24" EXCEPT WHERE INDICATED ON FINISHES PLAN WITH WALL TILE MARKER OR KEY NOTE SPECIFYING WALL TILE. RE: INTERIOR ELEVATIONS.
- PAINT ALL GYP. BD. CEILINGS PT02 U.N.O.

SHEET KEYS

- EXISTING CARPET TILES TO REMAIN IN NEW OFFICES. DEMO / PATCH AS NECESSARY PER NEW PARTITION LAYOUT.

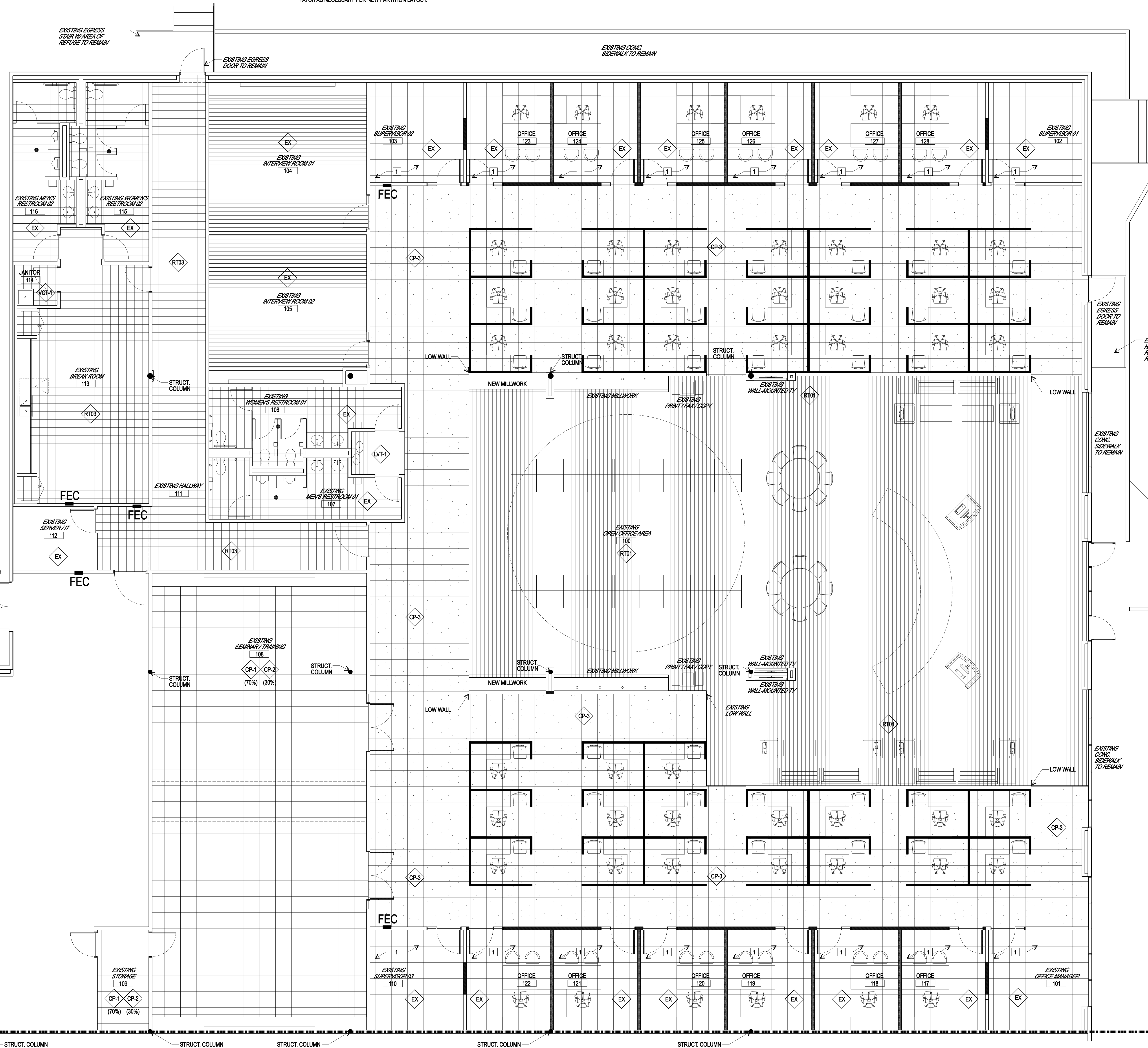

01 FINISHES PLAN

SCALE: 3/16" = 1'-0"



ISSUES AND REVISIONS

DATE	DESCRIPTION
06.14.18	ISSUED FOR PROCA, PERMITTING & CONSTRUCTION
01	

NM21
DESIGN STUDIO, LLC
nathan moore
936.648.1468
nathanmoore21@gmail.com



PROJECT NAME:
WORKFORCE SOLUTIONS - SOUTHEAST:
INTERIOR REMODEL

PROJECT ADDRESS:
12148-B GULF FREEWAY
HOUSTON, TX. 77034

SHEET NAME:
FIRST FLOOR
FINISHES PLAN

SHEET NUMBER:
A314